

# LIFELINE ADJUSTER WITH HAND SWAGE

316 STAINLESS STEEL



Import



Precision  
Machined



Stamped

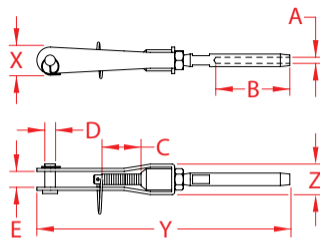

ITEM	A (wire)	B	C	D	E	X (height)	Y (length)	Z (width)	WT (lb)	PACKAGING TYPE	EACH (qty)	INNER (qty)	CARTON (qty)	UPC
S0745-H003	1/8"	1.38"	0.96"	0.24"	0.42"	0.62"	5.51"	0.74"	0.16	POLYBAG	1	10	200	791506050490
S0745-H005	3/16"	1.88"	0.96"	0.24"	0.42"	0.62"	6.15"	0.74"	0.18	POLYBAG	1	10	200	791506050506

**NOTE:**

**DESIGNED FOR HAND SWAGE USE ONLY. MAKE INSTALLATIONS PAINLESS, USING SUNCOR'S HAND SWAGE LIFELINE FITTINGS. USE THIS ADJUSTER WHERE QUICK ADJUSTMENT IS REQUIRED WITHOUT THE USE OF TOOLS. BODY AND SWAGE FITTING ARE MADE FROM GRADE 316 STAINLESS STEEL. CRIMP THE HAND SWAGE STUDS ONTO THE WIRE ROPE USING THE HAND SWAGER (PART # E0113-H600). USE HAND SWAGER HOLE #1 ON 1/8" WIRE AND HOLE #2 ON 3/16" WIRE. ALL DIMENSIONS ARE NOMINAL (+/- 3%) AND ARE SUBJECT TO CHANGE WITHOUT NOTICE.**